

EVERESTnano™ Green Pulsed Laser

AP-515

Applications:

- Cutting, drilling and scribing (glass, silicon, ceramics, flexible circuits)
- Thin film patterning (metal, thin film solar cells)
- Marking (glass, silicon, ceramics, metals, plastics)

Features:

- Nanosecond pulses
- High pulse energy and peak power
- High repetition rate capability
- Near diffraction limited beam quality
- Rugged OEM package and compact size



Optical Characteristics:

Parameter	Specification			
Operation mode	Pulsed			
Operating wavelength	515 nm (Green)			
Average power	10 W	20 W	30 W	50 W
Pulse repetition rate (kHz)	100 kHz	200 kHz	300 kHz	500 kHz
Pulse width	5 ns			
Pulse energy	100 μJ			
Beam quality, M ²	< 1.2			
Output power stability	Within ±5%			
Output delivery	Collimated output beam			

(For custom requirements, please contact AdValue Photonics)

Specifications subject to change without notice

General Characteristics:

Parameter	Specification
Operating temperature	10 to +30 °C
Storage temperature	+5 to +70 °C
Cooling	Water cooled (non-DI water, portable recirculating chiller available as an option)
Power requirement	AC 100~240 V (50/60Hz) (operating with AdValue Photonics Control Unit)
Warm-up time	10 minutes
Package dimensions	345(W) x 420(D) x 122(H) mm

Mechanical Outline:

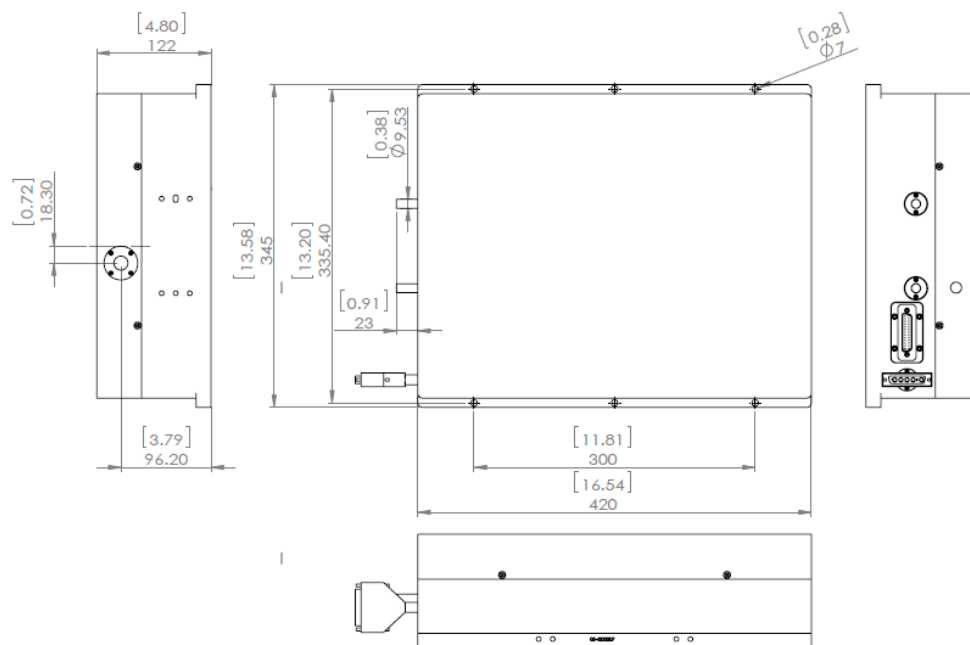

Ordering Information:

Part Number: AP - 515 - xx - xxx

Standard Wavelength:
515 = 515 nm

Output Power:
10 = 10 W
30 = 30 W
xx = xx W

Pulse Energy:
050 = 50 μJ
100 = 100 μJ

Specifications subject to change without notice